

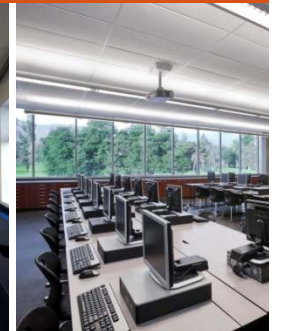

VPHS IMPLEMENTATION PLAN

Board of Education Meeting

October 2, 2014



VILLA PARK HIGH SCHOOL

what's next?





“academics, arts, athletics” / master plan



LPA

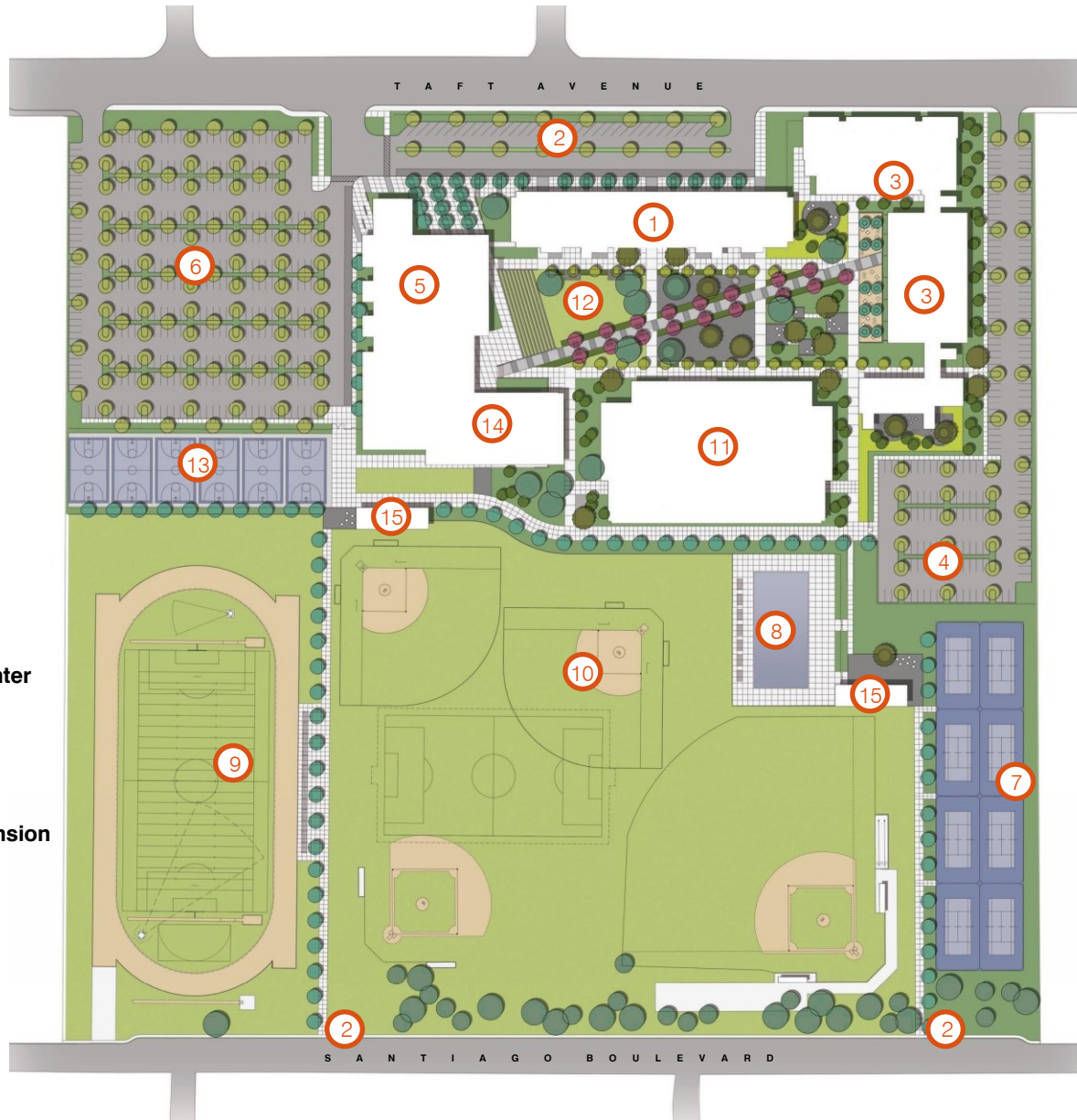



permanent classrooms	34%
science	23%
performing arts center	14%
student union	9%
renovation of 100 building	5%
athletic track	5%
new gym facilities	5%
discrete parking + circulation	5%

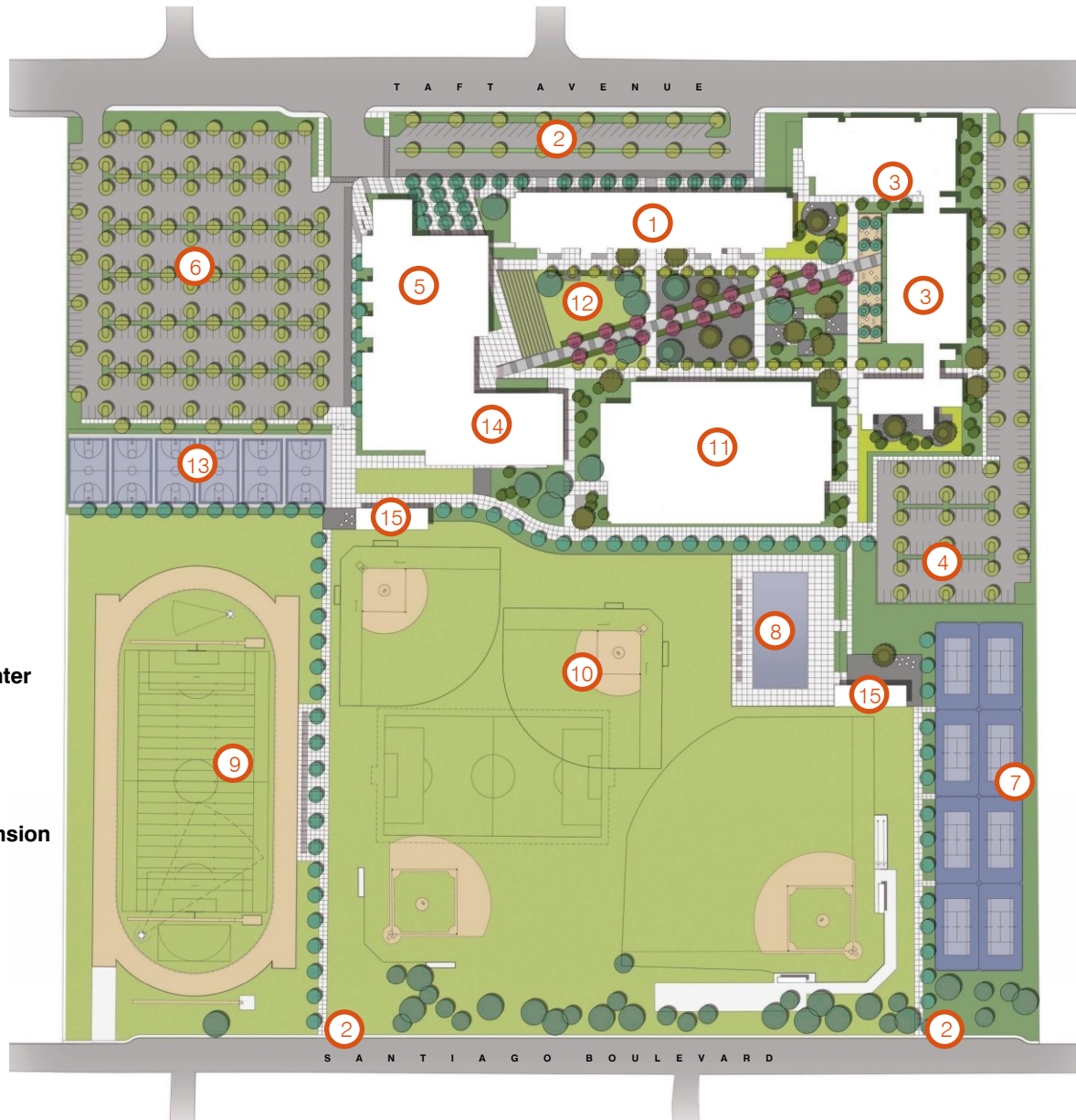

- 1 Academic Renovation
- 2 Drop Off
- 3 New Academic Building
- 4 Faculty Parking
- 5 New Performing Arts Center
- 6 Student Parking
- 7 New Tennis Courts
- 8 New Aquatic Center
- 9 New Track + Field
- 10 New JV Softball Field
- 11 Gym Renovation + Expansion
- 12 Quad Renovation
- 13 New Basketball Courts
- 14 New Student Union
- 15 New Field Building



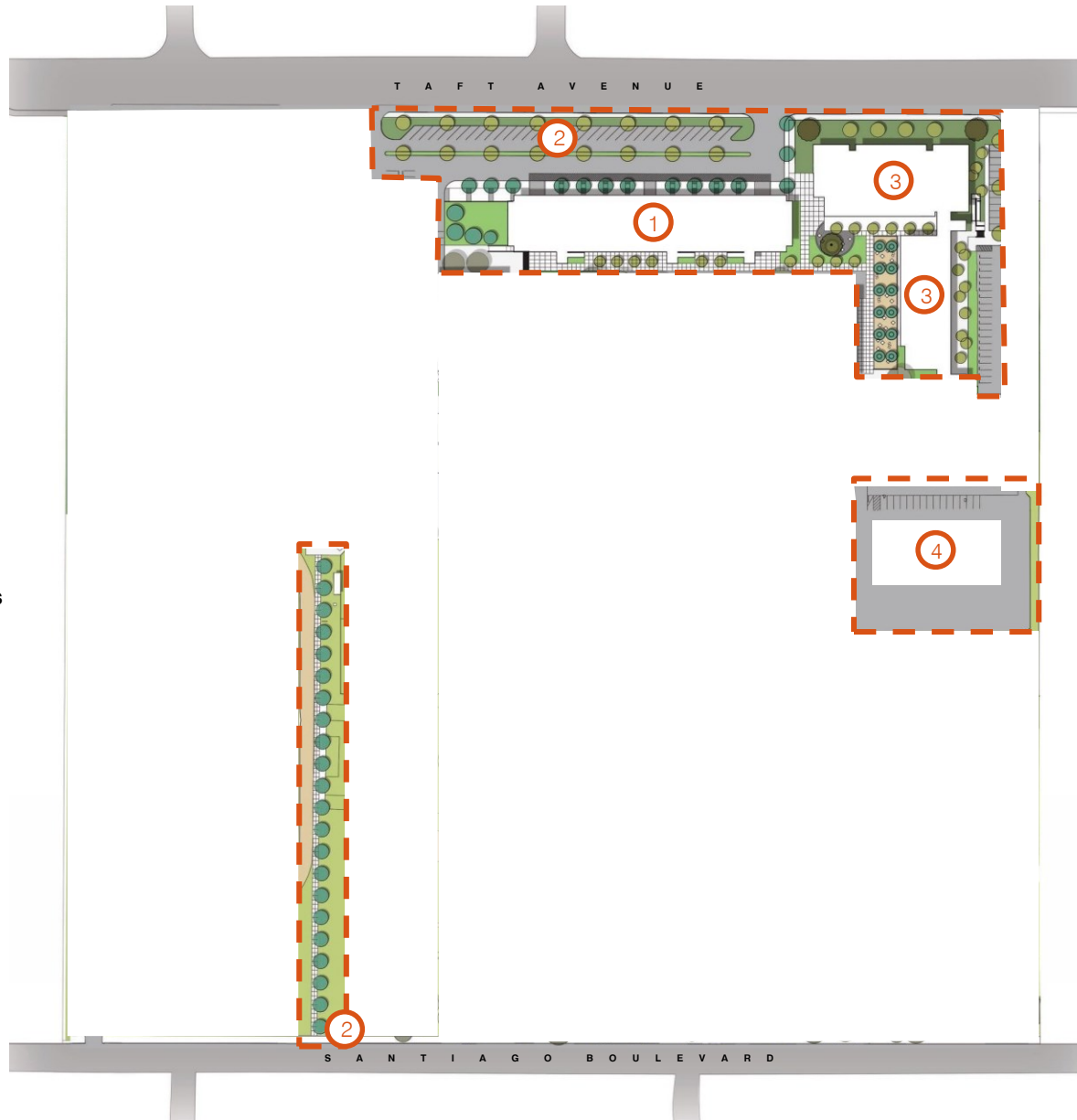

- 1 Academic Renovation
- 2 Drop Off/Campus Access
- 3 New Academic Building
- 4 Existing Portables





program legend

- academic classroom
- science classroom
- athletic
- performing arts
- media arts
- student services
- support

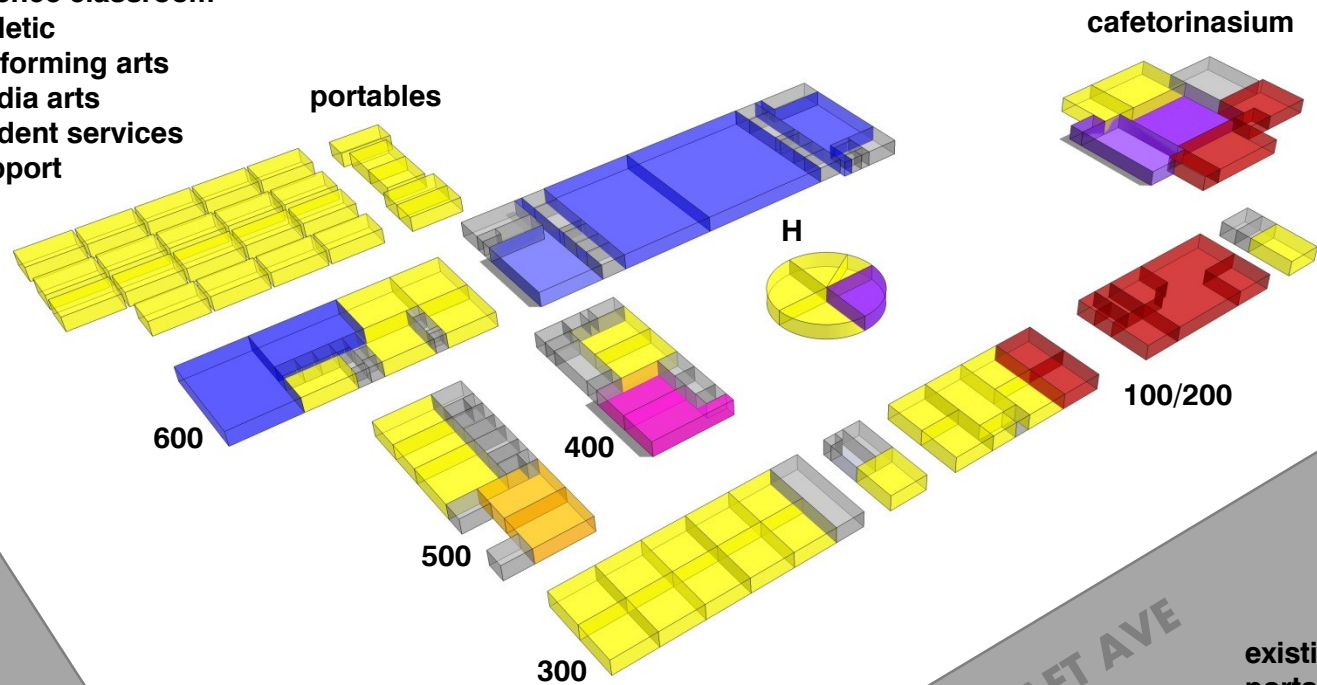

E. TAFT AVE

existing classroom count	60
portables	<u>24</u>
total	84



program legend

- academic classroom
- science classroom
- athletic
- performing arts
- media arts
- student services
- support

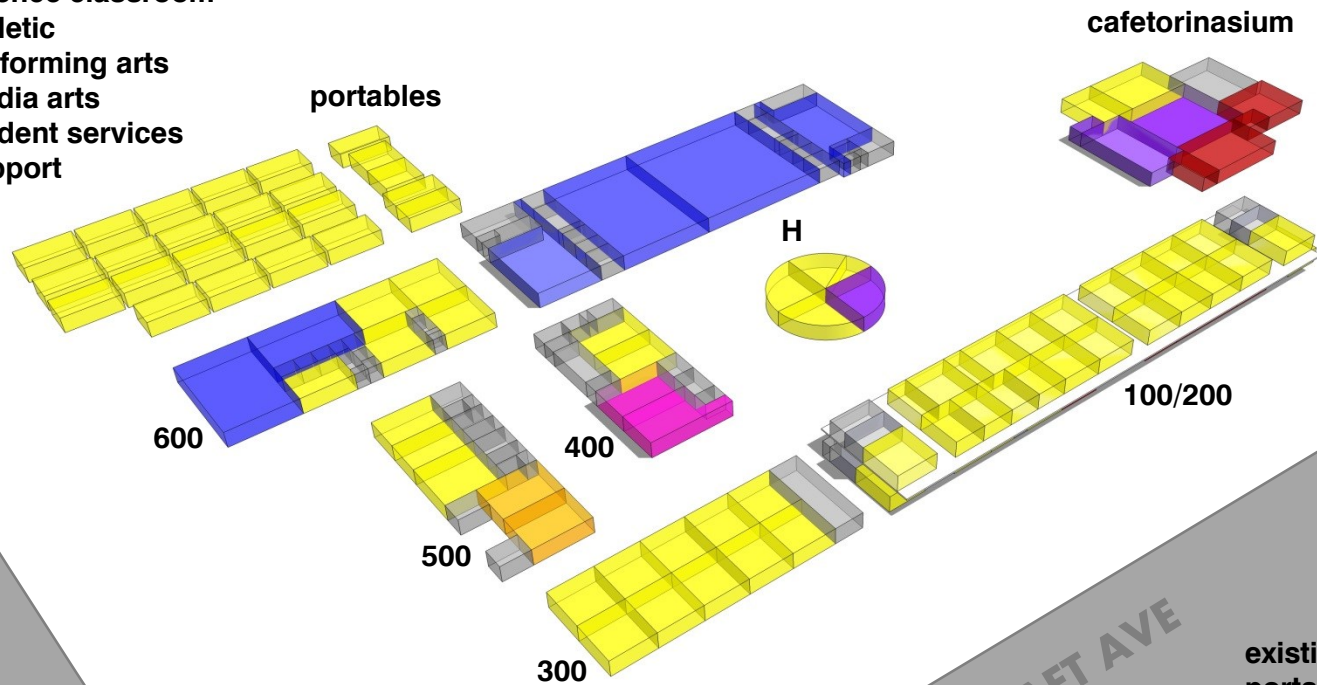

existing classroom count	60
portables	<u>24</u>
total	84



program legend

- academic classroom
- science classroom
- athletic
- performing arts
- media arts
- student services
- support

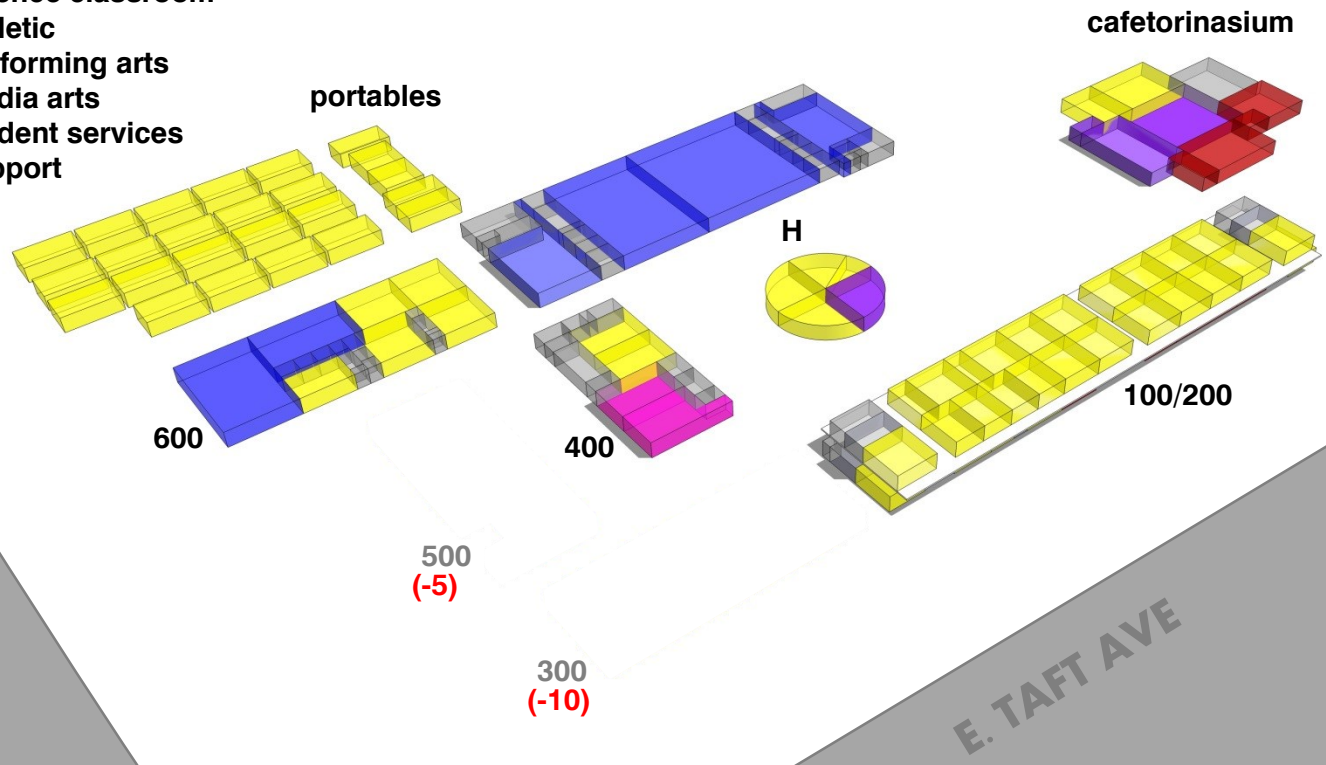



program legend

- academic classroom
- science classroom
- athletic
- performing arts
- media arts
- student services
- support

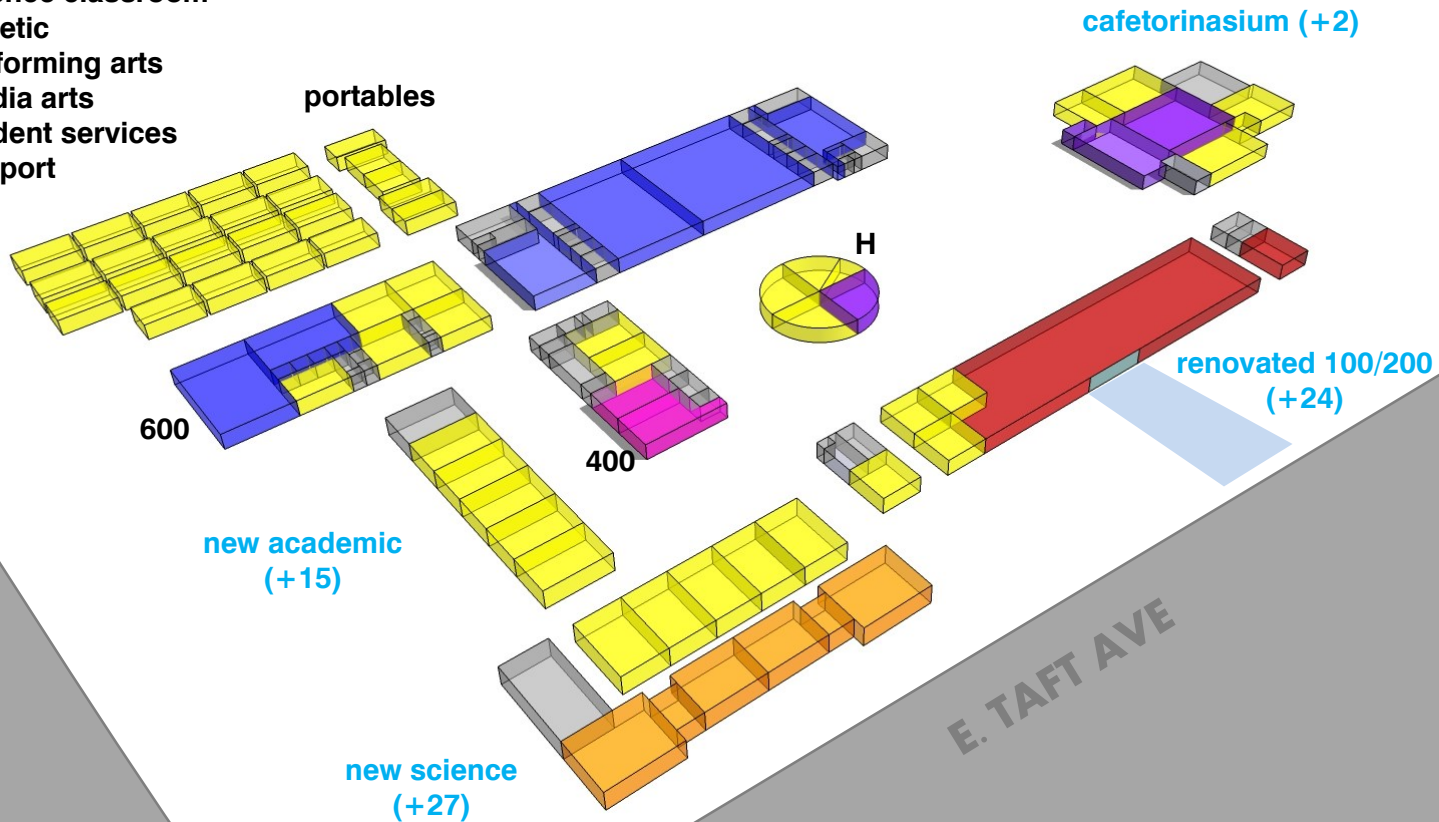



program legend

- academic classroom
- science classroom
- athletic
- performing arts
- media arts
- student services
- support

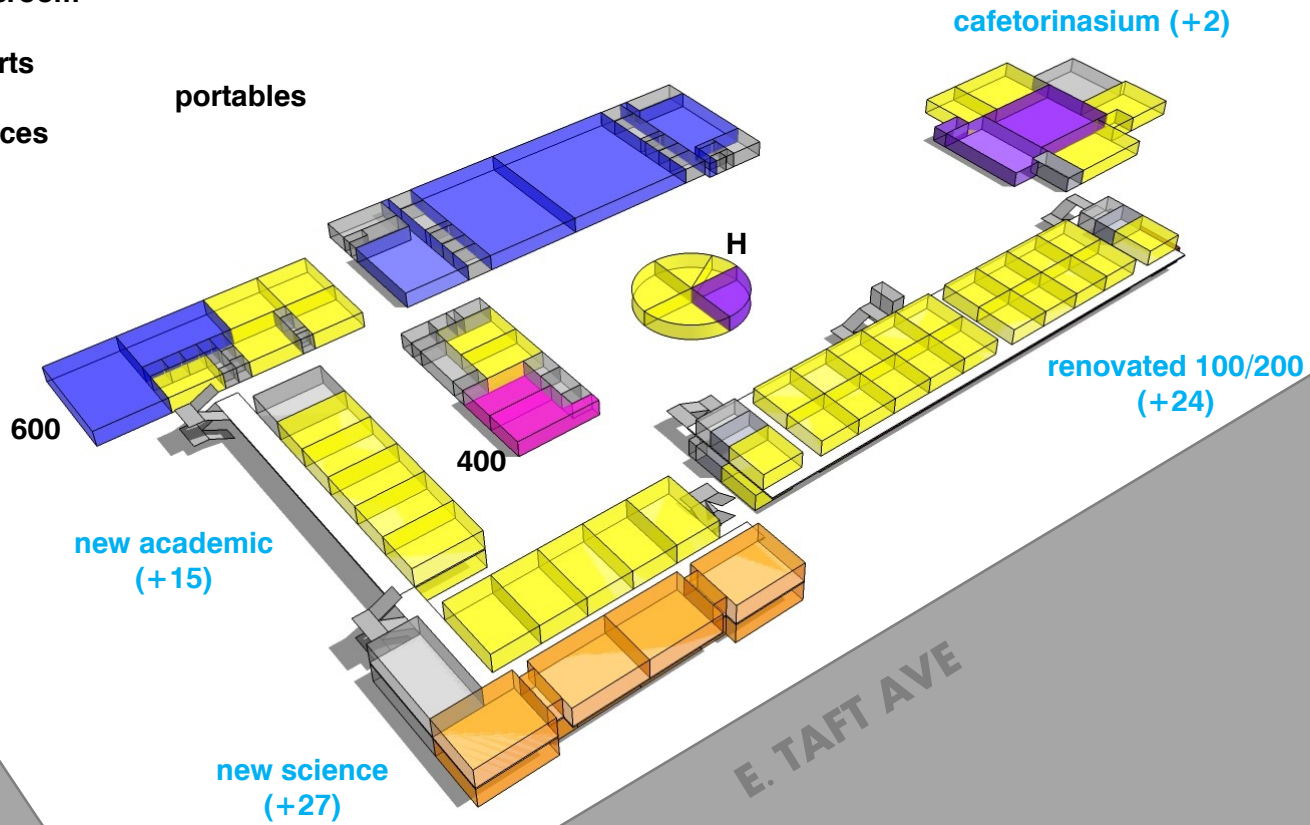



program legend

- academic classroom
- science classroom
- athletic
- performing arts
- media arts
- student services
- support

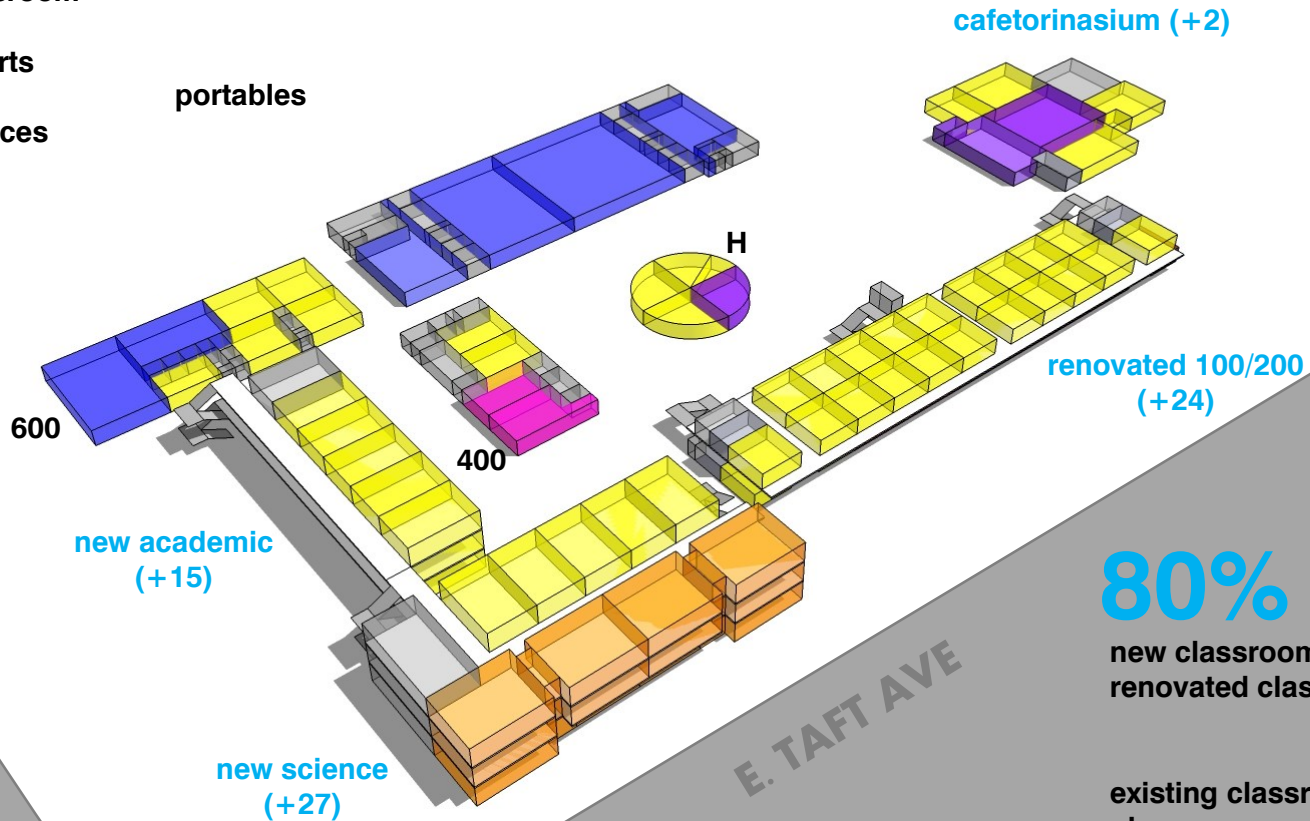

80% NEW

new classrooms	42
renovated classrooms	<u>26</u>
	68
existing classrooms	<u>18</u>
phase one completion	86
portables	24



“a focus on academics”

/ implementation plan



LPA



proposed / renovated building 100/200 level 1

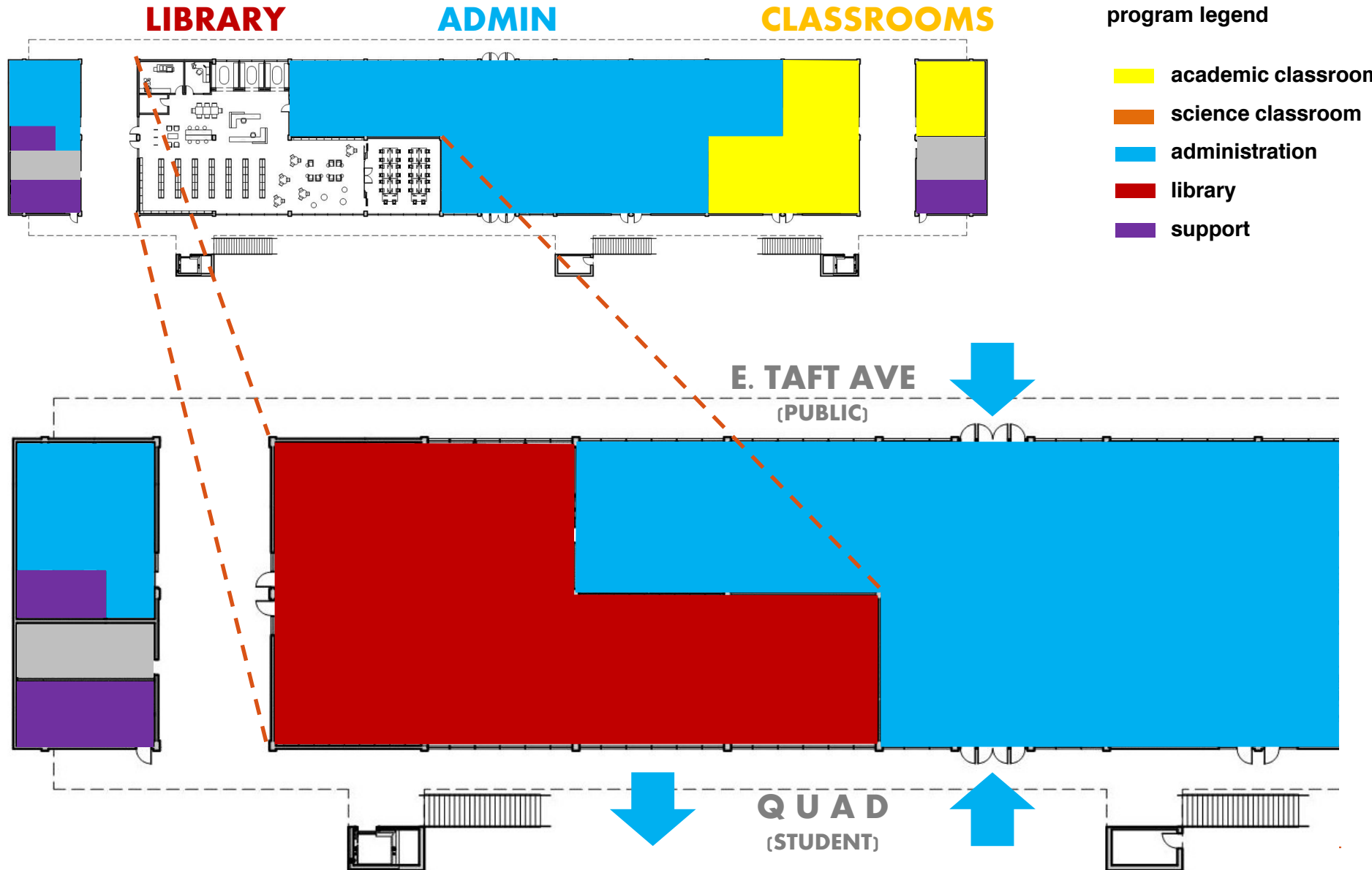



The NEXT ENTRANCE



FUN AND WELCOMING
NEW IDENTITY



SECURE POINT OF ACCESS



COUNSELOR OF THE DAY

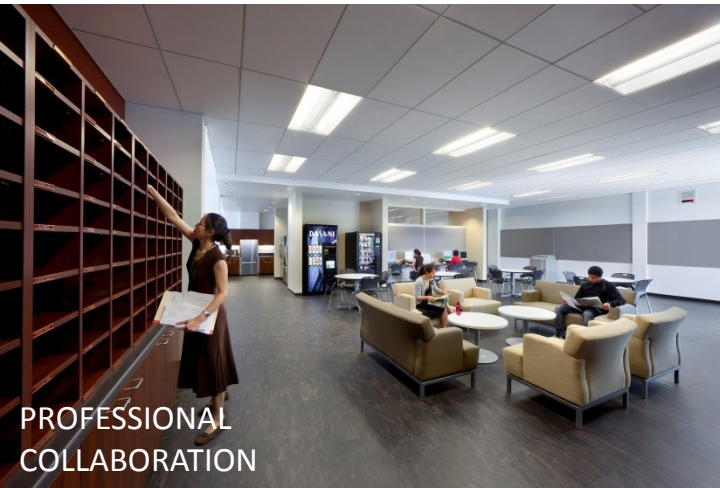

PROFESSIONAL
COLLABORATION

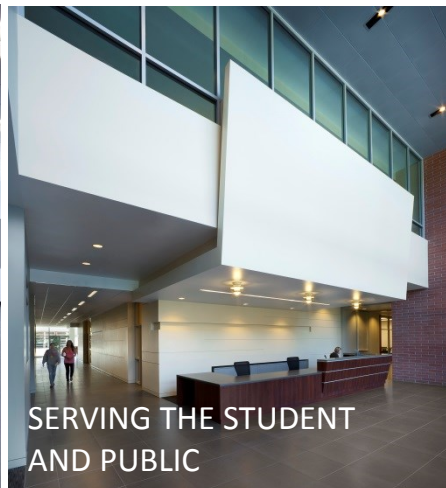

SERVING THE STUDENT
AND PUBLIC





The NEXT LIBRARY



MULTIPLE ZONES
/ MULTIPLE DEVICES
+ PERSONAL DEVICES = WI-FI



COLLABORATION SPACES

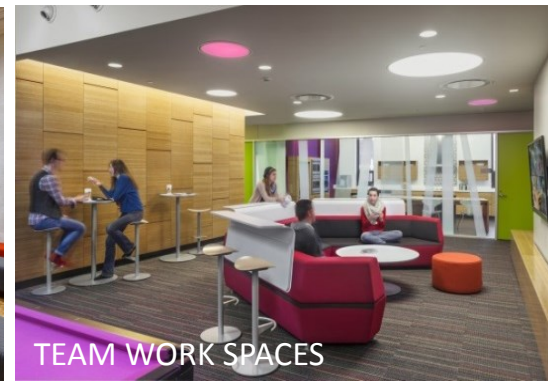
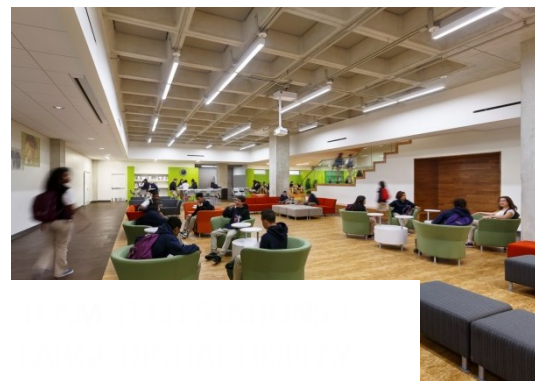

TEAM WORK SPACES





CLASSROOMS

program legend

- academic classroom
- science classroom
- administration
- library
- support

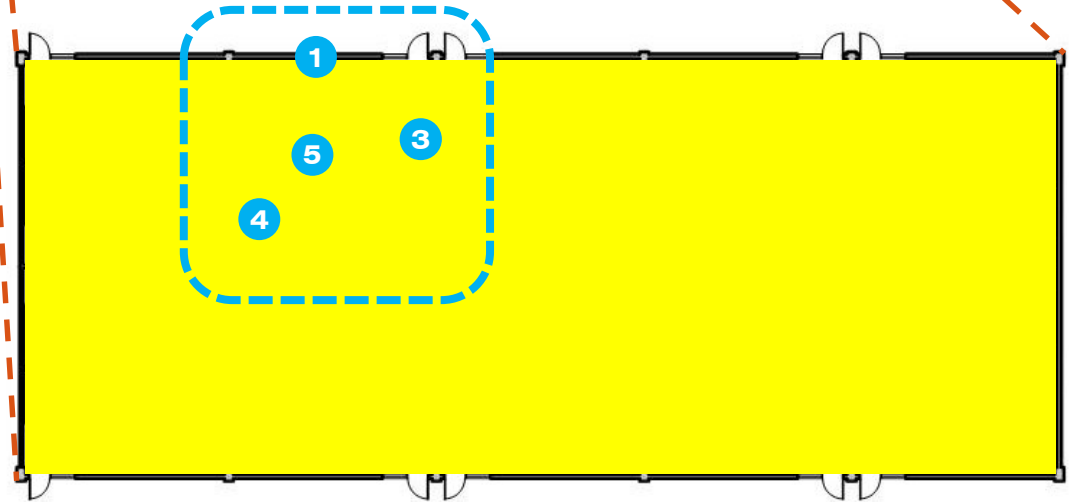
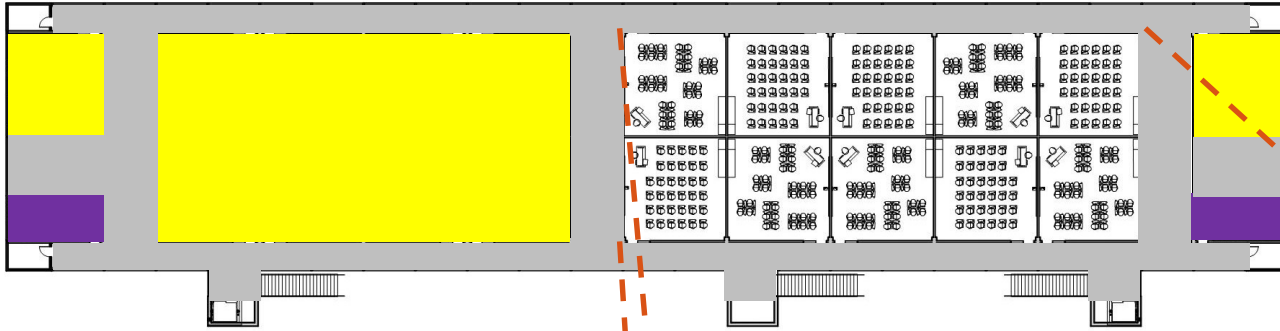

classroom legend

- 1 natural daylight + views
- 2 student lockers
- 3 classroom technology
- 4 built-in storage
- 5 flexible furniture





program legend

- academic classroom
- science classroom
- administration
- library
- support

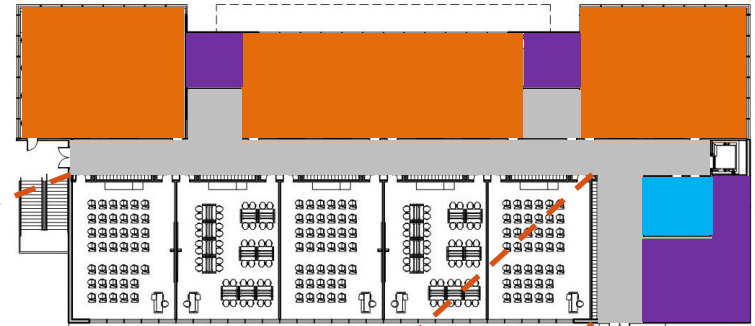

CLASSROOMS

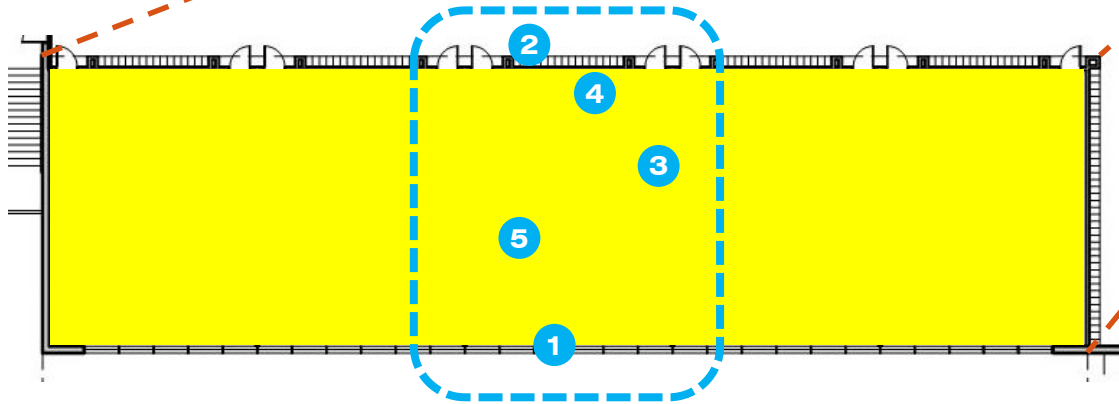

classroom legend

- 1 natural daylight + views
- 2 student lockers
- 3 classroom technology
- 4 built-in storage
- 5 flexible furniture





classroom features
student centered
flexible furniture
movable storage options
seamless technology integration
transparent connections
multiple "learning walls"
sustainable spaces

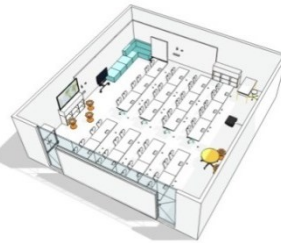

Presentation

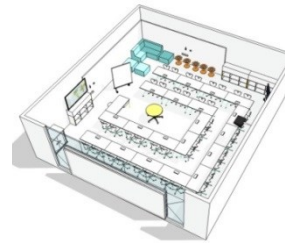

Discussion



Team Work



Project Based



The NEXT CLASSROOM

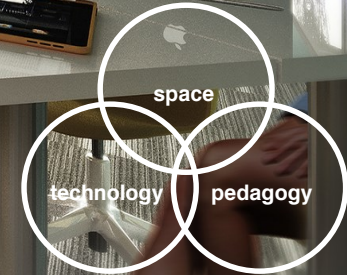



program legend

- academic classroom
- science classroom
- administration
- library
- support

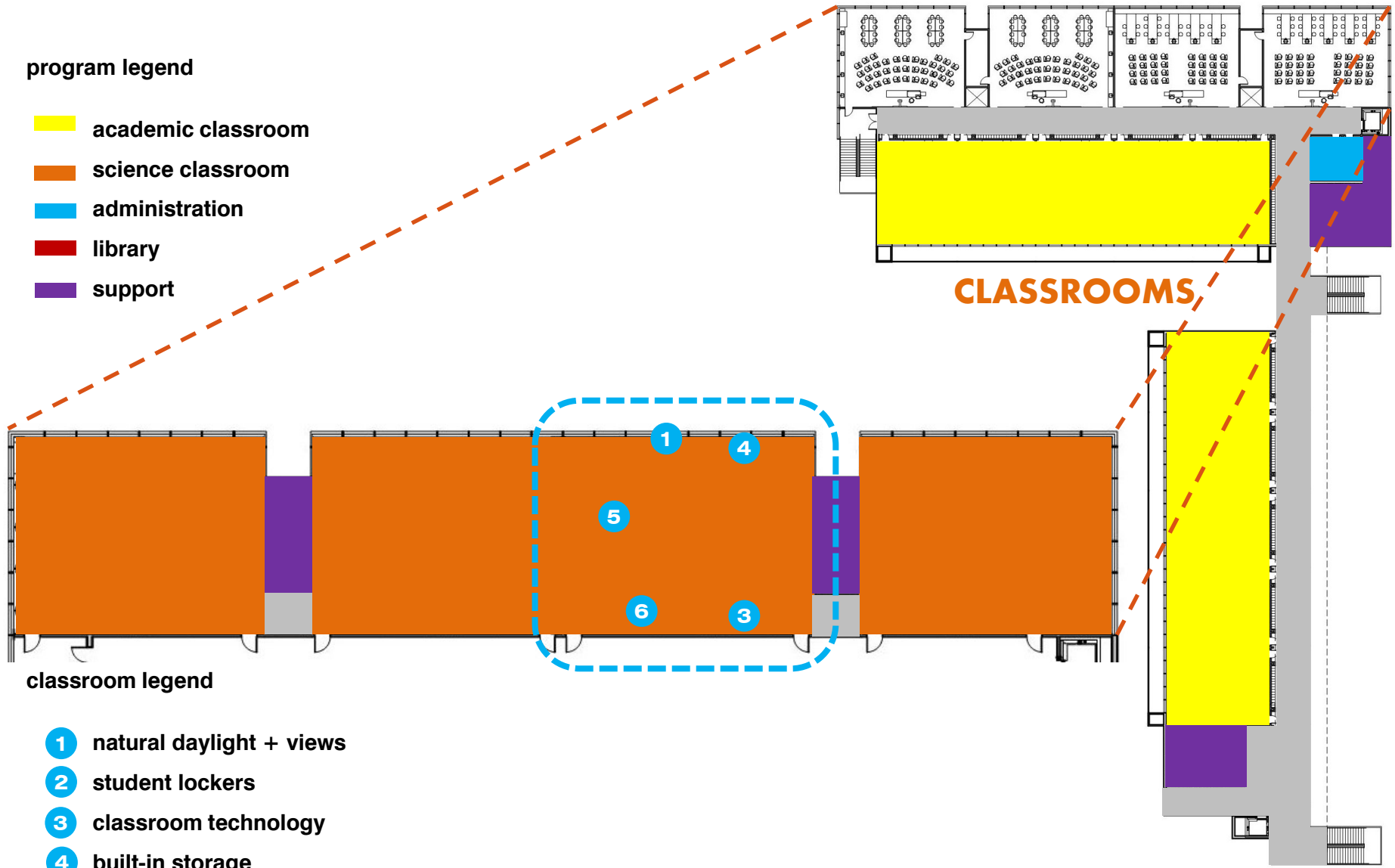

classroom legend

- 1 natural daylight + views
- 2 student lockers
- 3 classroom technology
- 4 built-in storage
- 5 flexible furniture (lecture + lab)
- 6 mobile teaching workstations





proposed / renovated entrance

The NEXT SCIENCE LAB



INTEGRATED TECHNOLOGY



EXPLORATION



DISCRETE LECTURE + LAB



LPA



/ new 21st century learning environments



LPA



/ a real sense of spartan pride



LPA



/ a new face to the community



LPA



LPA



creating sustainable places and spaces that enrich the lives of those who use them